



GENERAL FEATURES

- Rack size **60x50 cm**
- Gross weigh 81,5 Kg
- Washing cycle/racks/hour:
2'-3'-6'-9' / 30-15-10-7
- Lower and upper wash/rinse arms
- Wash pump: 680 W
- Boiler capacity: 5,5 liters
- Tank capacity: 22 liters
- Boiler heating element: 6,0 kW
- Tank heating element: 2,4 kW
- Water quantity per cycle: 2 liters
- Electronic controls LCD display
- Useful washing height: 400 mm
- Magnetic door microswitch
- Automatic water filling
- Double electric detergent and rinse dispenser
- Hot rinse
- Thermostop function
- PRS system (Atmospheric Boiler+Break tank)
- Green Functom for energy saving
- Automatic end-of-day self cleaning of water
- Washing pump with Soft-start

FILTRATION

- Removable plastic pump filter in several sections
- Stainless steel surface filters
-

BODY

- AISI 304 stainless steel Body
- Double skinned body
- Preformed wash tank
- Preformed rack guides
- Door handle in s/s
- Wash/rinse arms in s/s, easily removable
- Boiler in s/s AISI 304
- PVC protection rear the bottom front panel

EQUIPMENT AS GLASSWASHER

- 1 stainless steel rack 4 trays
- 1 utensil basket 60x50 cm
- 1 inlet hose (length 2 m)
- 1 drain hose (length 2,5 m)

OPTIONAL

- Drain pump
- Cold rinse
- HD version (P.Tot. 9,08 kW, solo in 380-415V3N~)
- Hot water filling
- Kit 4 high feet

ACCESSORIES FOR WATER TREATMENT

- Integrated water softener unit ("S" model)

ACCESSORIES

- Special baskets
- S/S supporting stand h. mm. 550 for basket

INSTALLATION

- Use the screws of the feet and a spirit level to ensure that the machine is levelled

MAIN POWER SUPPLY

- The voltage of main power supply must be compatible with the rated voltage
- The machine must be connected to a suitable earth (ground) system
- Connect the machine power socket to the multipole wall switch provided

WATER SUPPLY CONNECTION

- A water softener must be installed if the water is hard
- The water pressure must be between 0.2MPa (2 bar), and, 0.5MPa (5 bar)
- The temperature of the water-supply must be between 10°C to 50°C

TECHNICAL SPECIFICATIONS

- Voltage: **400V3N/230V3/230V~50 Hz**
- Total power: **6,68 kW**
- Amperage: **10 A / 17 A / 28 A**
- Power cord supply size: **5 x 2,5 / 3 x 4 mmq**

AU 60.40^E PRS

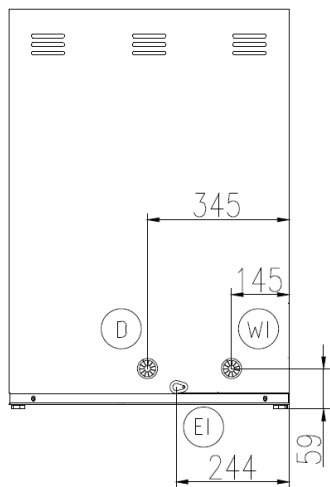
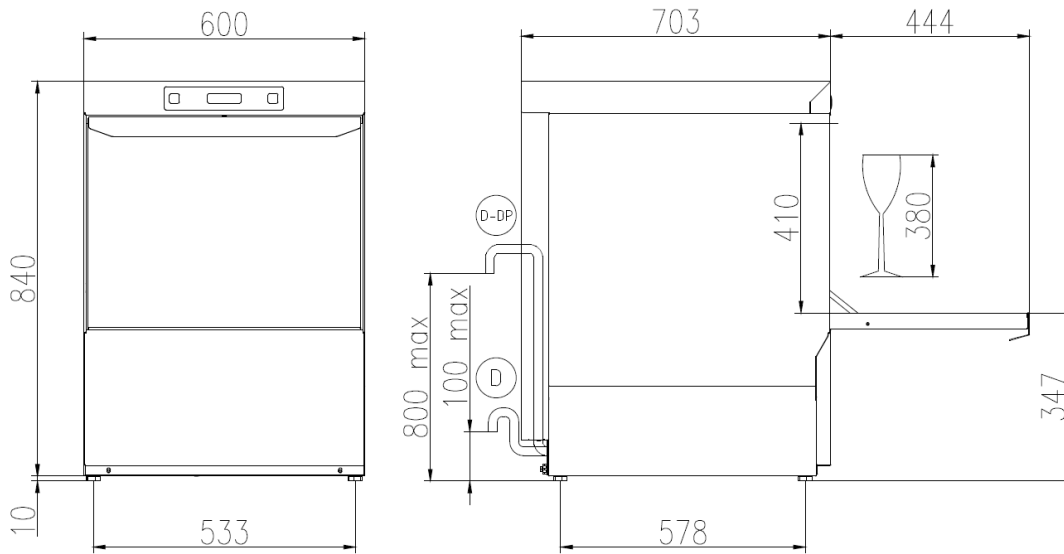

- (EI)** CAVO DI ALIMENTAZIONE
POWER CORD SUPPLY
CABLE D'ALIMENTATION
CABLE DE ALIMENTACION
- (WI)** CANNA DI CARICO G 3/4 L=2000 mm
G 3/4 INLET HOSE L=2000 mm
TUYAU D'ALIMENTATION G 3/4" L=2000 mm
TUBO DE ALIMENTACION G 3/4" L=2000 mm
- (D)** TUBO DI SCARICO ø 29 mm L=2500 mm
DRAIN HOSE ø 29 mm L=2500 mm
TUYAU DE VIDANGE ø 29 mm L=2500 mm
TUBO DE DESAGUE ø 29 mm L=2500 mm
- (D-DP)** TUBO DI SCARICO ø 29 mm L=2500 mm (CON POMPA SCARICO)
DRAIN HOSE ø 29 mm L=2500 mm (WITH DRAIN PUMP)
TUYAU DE VIDANGE ø 29 mm L=2500 mm (AVEC POMPE DE VIDANGE)
TUBO DE DESAGUE ø 29 mm L=2500 mm (CON POMPA DE DESAGUE)

	Min 10°C—MAX 50°C
	Min 10°C—MAX 25°C with ENERGY RECOVERY
	200÷500kPa(2÷5 Bar)
	100÷500kPa(1÷5 Bar) with ATMOSPHERIC BOILER
	HARDNESS 5÷20 ^f —2.8÷11 ^d